

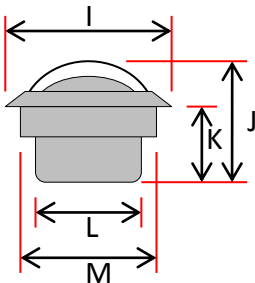

TECHNICAL SPECIFICATIONS

	GZUT 25SQX
Cone (Dome)	High shape coated silk dome
Cone color	Black
Surround	Coated silk
Dustcap	-
Basket / Frame material	Machined aluminum
Basket / Frame color	Front: Black anodized / Back: Copper anodized
Terminal	Cable
Magnet	1 x Neodymium with coupled chamber
Voice coil	25 mm / 1" copper round wire
Voice coil former	Aluminum
RE	3.2 Ohm
SPL	91 dB
FS	750 Hz
Frequency response	2 – 25 kHz
Powerhandling	70 / 120 W
Outer diameter	49 mm / 1.93"
Mounting diameter	43.10 mm / 1.7"
Mounting depth	22 mm / 0.87"



I	49 mm / 1.93"
J	34 mm / 1.34"
K	22 mm / 0.866"
L	33 mm / 1.299"
M	43.10 mm / 1.7"



TECHNICAL SPECIFICATIONS

